

Greene County Commission Briefing  
Commission Office  
1443 N. Robberson, 10th Floor  
May 28, 2019  
9:15 a.m.

Attendees: Bob Dixon, Harold Bengsch, John Russell, Justin Hill, Dan Patterson, Jeff Scott, Tina Phillips, Mike Cagle, Rick Artman Maily Jeffries Amanda Corcoran and Megan Applegate.

Budget Officer Jeff Scott informed Commission that the budget office is currently working on a project involving LEST II. Next Tuesday 06/04/2019 a bond update meeting will be held at the Commission office.

Human Resource Director Maily Jeffries discussed longevity pay. Jeffries mentioned that she reached out to surrounding counties and all the counties that were contacted did not have a policy in place. The City of Springfield pays a lump one time \$500 payment that is stretched out over 12 months. Jeffries also explained that she is waiting to hear back from City Utilities. Commissioner Dixon ask that once she hear back from CU that she report back to the Commission with the information.

PIO Donna Barton informed Commission that the Rotunda for June is complete and that going forward the Rotunda will go out in the 2<sup>nd</sup> week of the month.

Prosecuting Attorney Dan Patterson updated Commission that his office is currently down two attorneys. Patterson informed Commission that his office is currently up 21% on felony case referrals for the first 4 months of the year. Up 34% on felony case filing.

Captain David Johnson with the Greene County Sheriff's Office updated Commission that the jail population was 887. 852 is the monthly average for May and Johnson explained that this time last year the average daily population was 744.

Highway Director Rick Artman presented the Commission with a Warranty Deed(EX1) for the Florence I. Edmondson Living Trust located near Farm Road 129. Commissioner Harold Bengsch moved to approve the Warranty Deed. Commissioner Russell seconded the motion and it was unanimously approved. Aye: Dixon, Bengsch and Russell. Nay: none Abstain: None. Absent: None

Deputy Budget Officer Tina Phillips presented the Commission with the monthly May transfer for future principal, interest and trustee payments on bonds. (EX 2)Commissioner Bob Dixon moved to approve the monthly May transfers. Commissioner Russell seconded the motion and it was unanimously approved. Aye: Dixon, Bengsch and Russell. Nay: none Abstain: None. Absent: None.

Budget Officer Jeff Scott presented the Commission with Certification of understanding of section 5.02 of COP series 2018 trust agreement (EX 3) Commissioner John Russell moved to approve the trust agreement. Commissioner Harold Bengsch seconded the motion and it was unanimously approved. Aye: Dixon, Bengsch and Russell. Nay: none Abstain: None. Absent: None.

With no other business the meeting was adjourned.

21

## WARRANTY DEED

THIS INDENTURE, Made on the 19<sup>th</sup> day of May, 2019  
A.D. by and between FLORENCE I. EDMONDSON LIVING TRUST,  
parties of the first part, Grantor, and Greene County, State of Missouri Grantee,  
Mailing Address: Greene County Courthouse, Springfield MO 65802, of the  
County of Greene, in the State of Missouri, party of the second part.

WITNESSTH, That the said parties of the first part, in consideration of  
the sum of One Dollars (\$1.00) and other good and valuable consideration, to said  
party of the second part, the receipt of which is hereby acknowledged, does by  
these presents, GRANT, BARGAIN AND SELL, CONVEY AND CONFIRM, unto the  
said party of the second part, its heirs and assigns, the following described lots, tracts or  
parcels of land lying, being and situated in the County of Greene and State of Missouri,  
to-wit:

*(See Attachment A)*

TO HAVE AND TO HOLD the premises aforesaid, with all and singular the  
rights, privileges, appurtenances and immunities thereto belonging, or in anywise  
appertaining, unto the said party of the second part, and unto its heirs and assigns forever,  
the said parties of the first part hereby covenanting that they are lawfully seized of an  
indefeasible estate in fee in the premises herein conveyed; that they have good right to  
convey the same; that the said premises are free and clear of any encumbrances done or  
suffered by it or those under whom it claims and that it will warrant and defend the title  
to the said premises unto the said party of the second part and unto its heirs and assigns  
forever against the lawful claims and demands of all persons whomsoever,  
except as follows: None.

IN WITNESS WHEREOF, the said parties of the first part has hereunto set its hand the day and year first above written.

Florence I. Edmundson Owner  
Florence Edmundson  
Owner

ACCEPTED: Greene County Commission

DATE:

Bob Dixon  
Bob Dixon,  
Presiding Commissioner

Harold Bengsch  
Harold Bengsch,  
Commissioner 1<sup>st</sup> District

John C. Russell  
John C. Russell,  
Commissioner 2<sup>nd</sup> District

Rick J. Artman  
Rick Artman, Administrator  
Greene County Highway Department

STATE OF MISSOURI       )  
  )   ss.  
COUNTY OF Greene       )

On the 19<sup>th</sup> day of May, 20 19,  
before me personally appeared Florence Edmundson

\_\_\_\_\_

to me known to be the person(s) described in and who executed the foregoing instrument, and acknowledged he/she executed the same as him/her free act and deed.

**IN TESTIMONY WHEREOF**, I have hereunto set my hand and affixed my official seal, at my office in Springfield, Missouri, the day and year first above written.

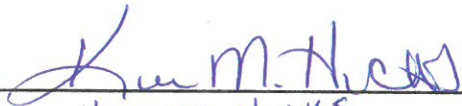
, Notary Public  
Kim M. Hicks

My Commission Expires: April 3, 2022



**EXHIBIT "A"**

**PERPETUAL STREET RIGHT OF WAY DESCRIBED AS FOLLOWS:**

ALL THAT PART OF LOT 1 OF HAMPDEN PARK, A SUBDIVISION RECORDED IN BOOK N, PAGE 32, IN THE GREENE COUNTY RECORDERS OFFICE, GREENE COUNTY, MISSOURI, BEING MORE PARTICULARLY DESCRIBED AS FOLLOWS:

**BEGINNING** AT THE NORTHWEST CORNER OF SAID LOT 1;

**THENCE** SOUTH 88°59'11" EAST, ALONG THE NORTH LINE OF SAID LOT 1, A DISTANCE OF 13.39 FEET;

**THENCE** SOUTH 02°15'02" WEST, A DISTANCE OF 163.04 FEET TO A POINT ON THE SOUTH LINE OF SAID LOT 1;

**THENCE** NORTH 88°54'45" WEST, ALONG SAID SOUTH LINE, A DISTANCE OF 13.49 FEET TO THE SOUTHWEST CORNER OF SAID LOT 1;

**THENCE** NORTH 02°17'11" EAST, ALONG THE WEST LINE OF SAID LOT 1, A DISTANCE OF 163.03 FEET TO THE **POINT OF BEGINNING**. (AS ILLUSTRATED IN SKETCH EXHIBIT "B")  
CONTAINING 2191 SQUARE FEET

AND

**STORM WATER DRAINAGE EASEMENT DESCRIBED AS FOLLOWS:**

ALL THAT PART OF LOT 1 OF HAMPDEN PARK, A SUBDIVISION RECORDED IN BOOK N, PAGE 32, IN THE GREENE COUNTY RECORDERS OFFICE, GREENE COUNTY, MISSOURI, BEING MORE PARTICULARLY DESCRIBED AS FOLLOWS:

**COMMENCING** AT THE NORTHWEST CORNER OF SAID LOT 1;

**THENCE** SOUTH 88°59'11" EAST, ALONG THE NORTH LINE OF SAID LOT 1, A DISTANCE OF 13.39 FEET TO THE **POINT OF BEGINNING**;

**THENCE** SOUTH 88°59'11" EAST, CONTINUING ALONG THE SAID NORTH LINE, A DISTANCE OF 35.01 FEET;

**THENCE** SOUTH 02°15'02" WEST, A DISTANCE OF 19.76 FEET;

**THENCE** NORTH 87°44'58" WEST, A DISTANCE OF 35.00 FEET;

**THENCE** NORTH 02°15'02" EAST, A DISTANCE OF 19.01 FEET TO THE **POINT OF BEGINNING**; (AS ILLUSTRATED IN SKETCH EXHIBIT "B")

CONTAINING 678 SQUARE FEET

AND

**TEMPORARY CONSTRUCTION EASEMENT DESCRIBED AS FOLLOWS:**

ALL THAT PART OF LOT 1 OF HAMPDEN PARK, A SUBDIVISION RECORDED IN BOOK N, PAGE 32, IN THE GREENE COUNTY RECORDERS OFFICE, GREENE COUNTY, MISSOURI, BEING MORE PARTICULARLY DESCRIBED AS FOLLOWS:

**COMMENCING** AT THE NORTHWEST CORNER OF SAID LOT 1;

**THENCE** SOUTH 88°59'11" EAST, ALONG THE NORTH LINE OF SAID LOT 1, A DISTANCE OF 13.39 FEET;



THENCE SOUTH 02°15'02" WEST, A DISTANCE OF 19.01 FEET TO THE **POINT OF BEGINNING**;  
THENCE SOUTH 87°44'58" EAST, A DISTANCE OF 10.00 FEET;  
THENCE SOUTH 02°15'02" WEST, A DISTANCE OF 16.91 FEET;  
THENCE SOUTH 87°44'58" EAST, A DISTANCE OF 15.00 FEET;  
THENCE SOUTH 02°15'02" WEST, A DISTANCE OF 20.00 FEET;  
THENCE NORTH 87°44'58" WEST, A DISTANCE OF 15.00 FEET;  
THENCE SOUTH 02°15'02" WEST, A DISTANCE OF 47.32 FEET;  
THENCE SOUTH 87°44'58" EAST, A DISTANCE OF 5.00 FEET;  
THENCE SOUTH 02°15'02" WEST, A DISTANCE OF 20.00 FEET;  
THENCE NORTH 87°44'58" WEST, A DISTANCE OF 5.00 FEET;  
THENCE SOUTH 02°15'02" WEST, A DISTANCE OF 39.60 FEET TO A POINT ON THE SOUTH LINE OF SAID LOT 1;  
THENCE NORTH 88°54'45" WEST, ALONG SAID SOUTH LINE, A DISTANCE OF 10.00 FEET;  
THENCE NORTH 02°15'02" EAST, A DISTANCE OF 144.03 FEET TO THE **POINT OF BEGINNING** (AS ILLUSTRATED IN SKETCH EXHIBIT "B")  
CONTAINING 1839 SQUARE FEET

THESE DESCRIPTIONS WERE PREPARED BY CJW TRANSPORTATION CONSULTANTS, LLC;  
CORPORATE LAND SURVEY NUMBER 2007008003.

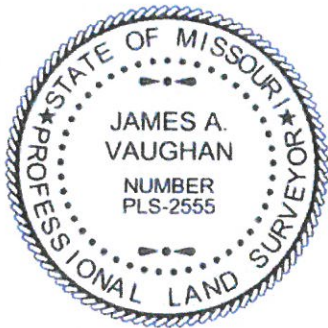

POINT OF BEGINNING - NEW RW  
NW CORNER LOT 1  
HAMPDEN PARK

POINT OF BEGINNING  
TEMPORARY  
CONSTRUCTION EASEMENT

NEW STREET RIGHT OF WAY  
2191 SQUARE FEET

FARM ROAD 129

S88° 59' 11"E  
13.39'

POINT OF BEGINNING  
DRAINAGE EASEMENT

KENT W. FRIEZE  
BOOK 1653 PAGE 1120

DRAINAGE EASEMENT  
678 SQUARE FEET

N02° 15' 02"E  
19.01'

S88° 59' 11"E  
35.01'

S02° 15' 02"W  
19.76'

S87° 44' 58"E  
10.00'

N87° 44' 58"W  
35.00'

S02° 15' 02"W  
16.91'

S87° 44' 58"E  
15.00'

S02° 15' 02"W  
20.00'

N87° 44' 58"W  
15.00'

S02° 15' 02"W  
47.32'

S87° 44' 58"E  
5.00'

FLORENCE EDMONDSON TRUST  
BOOK 2515 PAGE 2177

TEMPORARY CONSTRUCTION  
EASEMENT  
1839 SQUARE FEET

S02° 15' 02"W  
20.00'

N87° 44' 58"W  
5.00'

S02° 15' 02"W  
39.60'

N88° 54' 45"W  
13.49'

N88° 54' 45"W  
10.00'

THIS SKETCH IS NOT A BOUNDARY SURVEY. IT IS INTENDED TO SHOW  
THE CONFIGURATION OF NEW STREET RIGHT OF WAY, DRAINAGE  
EASEMENT AND TEMPORARY CONSTRUCTION EASEMENT.

GRID NORTH

MISSOURI COORDINATE SYSTEM  
1983 CENTRAL ZONE  
SCALE 1"=30'

DATE 03/12/19 CJW PROJECT No. 16017

5051 S. National  
Suite 7A  
Springfield, MO 65810  
Tel: 417.889.3400  
Fax: 417.889.3402  
www.GoCJW.com

SKETCH EXHIBIT "B"  
FLORENCE EDMONDSON TRUST  
NEW STREET RIGHT OF WAY, DRAINAGE AND  
TEMPORARY CONSTRUCTION EASEMENTS  
FARM RD. 146 AND FARM RD. 129  
& PART OF THE NE 1/4 SE1/4 OF S 29, T 29 N, R 22 W  
GREENE COUNTY, MISSOURI

Prepared by:  
**CJW**  
CJW Transportation  
Consultants, L.L.C.  
MO C.O.A. #2007008003

Bob Dixon  
Presiding Commissioner

Harold Bengsch  
1<sup>st</sup> District Commissioner

John C. Russell  
2<sup>nd</sup> District Commissioner



Shane Schoeller  
Clerk of the Commission

Christopher J. Coulter, AICP  
County Administrator

**COUNTY COMMISSION**  
**Greene County, Missouri**  
**(417) 868-4112**

May 28, 2019

Justin Hill  
Greene County Treasurer

Cindy Stein  
Greene County Auditor

Justin and Cindy;

Please transfer the following amounts for the month of May 2019 for future principal, interest and trustee payments on the indicated bonds.

<b>FROM</b>		
\$ (11,989.08)	101-96-49612	Other Funds Transfer: QECB 2011A
\$ (108,119.55)	101-96-49612	Other Funds Transfer: Build America Bond 2010A/Recovery Bond 2010B
\$ (56,170.00)	204-96-49100	Transfer from Other Funds: Build America Bond 2010A (911)
\$ (51,773.02)	207-96-49100	Transfer from Other Funds: Dan Kinney Park Project 2011B
\$ (479,110.42)	102-96-49100	Transfer from Other Funds: Series 2018
<u>\$ (707,162.07)</u>	<u>Total</u>	
<b>TO</b>		
\$ 707,162.07	301-96-49100	Transfers from Other Funds
<u>\$ 707,162.07</u>	<u>Total</u>	

Thank you. If you have any questions, please contact Jeff Scott at extension 1446.

  
Bob Dixon  
Presiding Commissioner

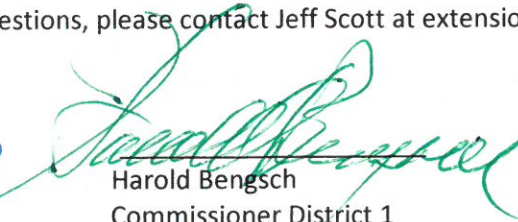
  
Harold Bengsch  
Commissioner District 1

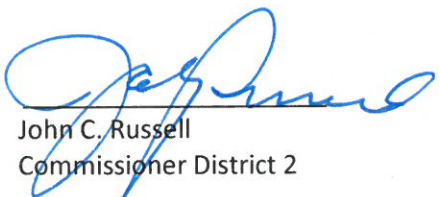
  
John C. Russell  
Commissioner District 2



23

**CERTIFICATES OF PARTICIPATION GREENE COUNTY, MISSOURI (CAPITAL  
PROJECTS) SERIES 2018**

Pursuant to Section 5.02 of the Indenture of Trust:

"The interest accruing thereon and any profit realized from such Investment Securities shall be credited to such Fund, and any loss resulting from such Investment Securities shall be charged to such Fund, except that interest accruing on moneys in the Construction Fund shall be credited to the Certificate Payment Fund."

The County hereby agrees that the pre-purchase date accrued interest included in the purchase price of the security will not be required to be transferred to the Certificate Payment Fund.

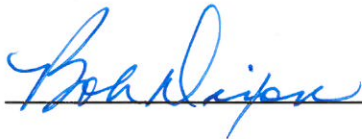

Authorized County Representative

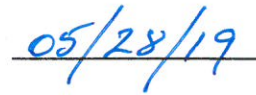

Date